

## Auspicious T2 - On/Off switch

Combined start / stop switch for mounting in a Ø22mm hole. Easy to mount with NO and NC terminals.

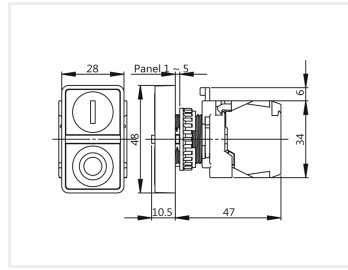
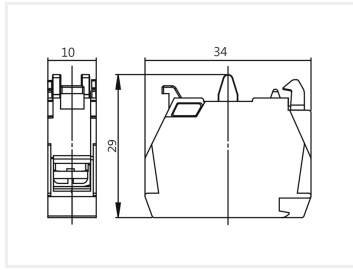

Combined start / stop switch for mounting in a Ø22mm hole. Easy to mount with NO and NC terminals. A complete solution consists of these separate parts you need to order:

- Switch
- Coupling
- Contact-block (1-2 pcs.)

Buy online at:

[www.matronics.eu/519060](http://www.matronics.eu/519060)

### Coupling

The coupling is simple pushed on to the bottom of the switch. The coupling is easy to take of again, by pushing the yellow parts, and pulling the coupling from the switch. This makes it easy to connect and replace.

### Contact-blocks

There is space for 2 contact blocks on a coupling. These are simply places in the coupling where they fasten. They are easy to remove again. The contact-blocks are activated when the switch is pushed down.

- NO contact block (green) connects the two screw-terminals when activated
- NC contact block (red) diconnects the two screw-terminals when activated



**Kontakt, Push-on / Push-off**  
SKU 519060



**Accessory, Rubber protection**  
SKU 519531



**Accessory, Coupling (required)**  
SKU 519510



**Accessory, Contact block (NO)**  
SKU 519500



**Accessory, Contact block (NC)**  
SKU 519501

