

## Serie 20 - Roller wheel (29x15mm)

Wheel in hard plastic, that fits in to serie 20 tracks (6mm). Can be used for securely guiding movable parts.

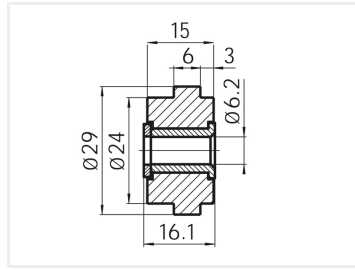

Wheel in hard plastic with a raised edge, that fits in to serie 20 tracks (6mm). The wheel is used for guiding movable parts in the track of the aluminium profile. This could be a sliding door or similar. The wheel is made of durable nylon. The bushing that is hammered in to the wheel is zinc plated steel.

The wheel is typically fastened with a M6 bolt through the bushing and the included washer.

Note that there is no bearing in the wheel, so the bolt should not be fastened too much through the wheel, as it will stop turning.

Buy online at:

[www.matronics.eu/A200501](http://www.matronics.eu/A200501)

### Specifications

Material Nylon and zinc plated steel



#### **Serie 20 - Roller wheel (29x15mm)**

SKU A200501

Dimensions: Ø29 x 15mm

Product pictures

