

Auspicious T2 - Enclosure

Enclosure with holes ready for 1-4 Auspicious T2 switches. Possibility for PG13.5 cable-gland in the end.

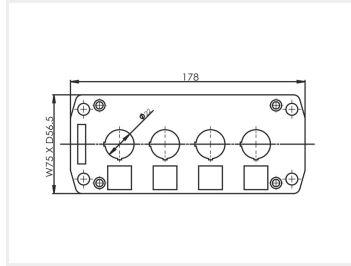
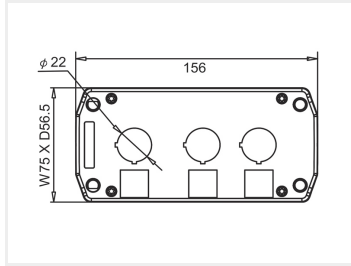
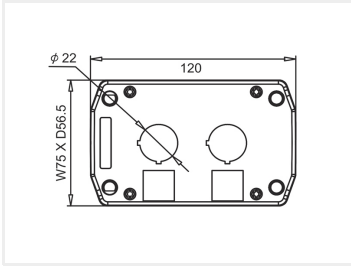
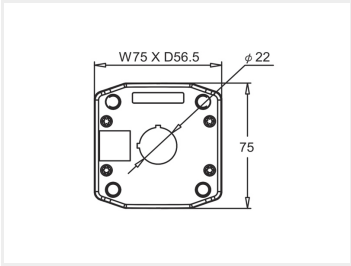

Enclosure with holes ready for 1-4 Auspicious T2 switches. Possibility for PG13.5 cable-gland in the end.

Buy online at:

www.matronics.eu/519401

The enclosure is closed with 4 screws, and there is also 4 holes to fasten the enclosure to a surface.



Gray/Black, 1 hole
SKU 519411



Gray/Black, 2 holes
SKU 519412



Gray/Black, 3 holes
SKU 519413



Gray/Black, 4 holes
SKU 519414



Yellow/Black, 1 holes
SKU 519401



Yellow/Black, 2 holes
SKU 519402



Yellow/Black, 3 holes
SKU 519403



Yellow/Black, 4 holes
SKU 519404



Accessory, Black PG13.5 cable gland
SKU 508003



Accessory, Black PG13.5 Nut
SKU 508013



Accessory, Black PG13.5 Stopper
SKU 508023



Accessory, Gray PG13.5 cable gland
SKU 508033



Accessory, Gray PG13.5 Nut
SKU 508043



Accessory, Gray PG13.5 Stopper
SKU 508053

Product pictures

