

Auspicious T2 - Emergency stop

Panel mounted emergency stop, for mounting in $\varnothing 22\text{mm}$ hole. Activated and held when pushed, and released by turning the head.

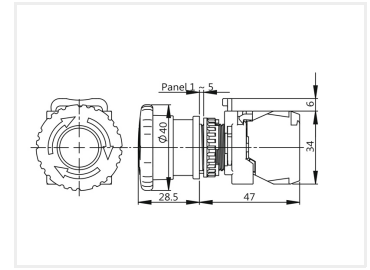
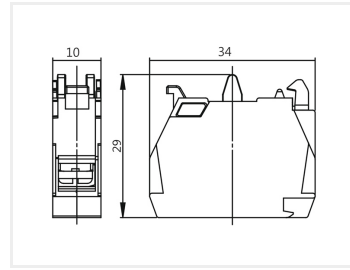

Panel mounted emergency stop, for mounting in $\varnothing 22\text{mm}$ hole. Activated and held when pushed, and released by turning the head. A complete emergency stop consists of the following parts:

- Switch
- Coupling
- Contact-block (1-2 pcs.)

There are also some accessory parts:

- Emergency stop label
- Cover to prevent unintended activation

Coupling

The coupling is simple pushed on to the bottom of the switch. The coupling is easy to take of again, by pushing the yellow parts, and pulling the coupling from the switch. This makes it easy to connect and replace.

Contact-blocks

There is space for 2 contact blocks on a coupling. These are simply places in the coupling where they fasten. They are easy to remove again. The contact-blocks are activated when the switch is pushed down.

- NO contact block (green) connects the two screw-terminals when activated
- NC contact block (red) disconnects the two screw-terminals when activated

Buy online at:

www.matronics.eu/519015



Push-Kontakt, Twist-release
SKU 519015



Accessory, Contact block (NO)
SKU 519500



Accessory, Shield
SKU 519533



Accessory, Coupling (required)
SKU 519510



Accessory, Contact block (NC)
SKU 519501



Accessory, Emergency stop sign
SKU 519534

Product pictures

